

# HANECO LED BATTEN INSTALLATION GUIDE

## SENTRY

Thanks for choosing our SENTRY weatherproof batten products.  
We strongly recommend that you read this manual carefully before installation.

### ⚠ WARNING

- The batten must be installed by professional electrician.
- Switch power off when wiring the LED batten.
- Ensure product is installed in a well ventilated area.
- Ensure input voltage conforms to the voltage range of product.
- Ensure wires are securely connected.
- Before switching on, ensure that all the wiring is correct.
- The warranty is void if product is not installed according to the instructions

### Product Specifications

Product Code	SENTRY40W12-TRI
Voltage/Frequency	220-240vac, 50-60Hz
Power	22/40W
Colour Temperature	3000K/4000K/5000K
Lumens	2420lm /2860lm/2640lm@ 22W 4400lm /5200lm/4800lm@ 40W
CRI	>80
IP Rating	IP65
IK Rating	IK10
Lifespan @50° L70	>54,000hr
Dimension (mm)	1285 x 96 x 115mm

### Installation Requirements

- This equipment must be installed and serviced only by a licensed and qualified electricians.
- All wiring and installation must comply with local and national wiring regulations, such as AS/NZS 3000 Electrical Standards.
- Before installation, check the product for any damage incurred during transport. Do not install or operate the product if it appears damaged. If damaged, return the complete product to the place of purchase for inspection, repair, or replacement.
- Avoid pulling or stressing any electrical wires during unpacking, as this may damage the connections.
- Always isolate the electrical supply before carrying out any work on this equipment.

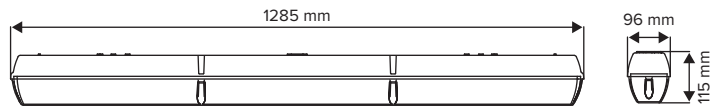

### Installation Instructions

#### In the package

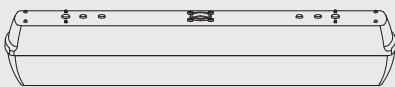

#### You will need:



4.5mm/8mm Drill bit



Electric Drill



Screw Driver (Flat and Philips head)



Safety Gear

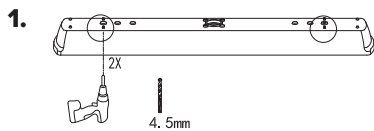

Carefully unpack the luminaire and disassemble the front cover and LED panel. Using a 4.5mm drill bit, drill through the center of the surface mount points on the back cover with an electric drill.

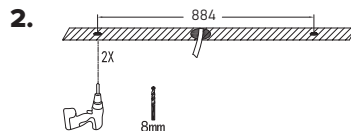

Ensure the power is turned off. Use the mounting template on the packaging to mark and drill mounting points with an 8mm bit.

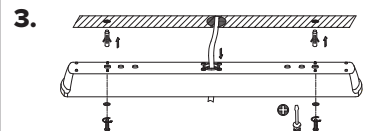

Carefully route the wire through the grommet. Do not remove the grommet to ensure the IP rating remains intact. Secure the back cover using the wall plug and screw provided.

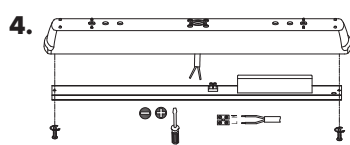

Set the desired colour temperature using the switch on the LED board. Connect the wire to the wiring point on the back of the LED board, and secure the board with the provided screw.

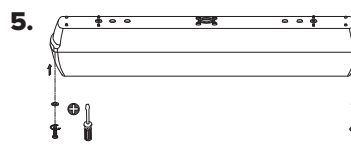

Secure the front cover using the provided screw and seals. Ensure all seals, gaskets, and cable grommets are properly inspected and in working condition before switch on electricity and operating the product.